

# THINSCAPE® FABRICATION & INSTALLATION GUIDE

Any fabrication procedure or technique not contained within the Wilsonart® Thinscape® Composite Tops Fabrication Manual will not be recognized by Wilsonart, LLC as an approved method of fabrication. Deviations from these techniques must be approved in writing by a Wilsonart Representative.

## TABLE OF CONTENTS

<b>GENERAL SAFETY .....</b>	<b>3</b>
<b>BEFORE YOU START-QUICK REFERENCE.....</b>	<b>4</b>
STORAGE AND HANDLING.....	4
FABRICATION .....	4
INSTALLATION .....	5
DO.....	5
DON'T .....	5
<b>STORAGE AND HANDLING.....</b>	<b>6</b>
HANDLING .....	6
STORAGE.....	6
INSPECTION.....	6
SHEET SELECTION PROCESS .....	6
<b>JOBSITE PREPARATION.....</b>	<b>7</b>
<b>RECOMMENDED TOOLS.....</b>	<b>8</b>
STATIONARY TOOLS .....	8
HAND & POWER TOOLS .....	8
<b>GENERAL TOPS, COUNTERTOPS, AND BACKSPLASHES .....</b>	<b>9</b>
DECK SEAMS .....	9
CONVENTIONAL SEAM.....	9
45° SEAM .....	9
CUTTING AND ROUTING .....	10
CUTTING & ROUTING (DRY) .....	10
WET SAW CUTTING .....	10
WET JET CUTTING.....	11
CUTOUTS .....	12
GENERAL CUTOUT REQUIREMENTS .....	12
SPECIAL CUTOUTS.....	12
BACKSPLASHES.....	14
WALL BACKSPLASH-CONVENTIONAL .....	14
WALL BACKSPLASH-LARGE/OVERSIZED .....	14
EDGE PROFILING & FINISHING .....	15

EDGE PROFILING.....	15
FINISHING.....	15
OVERHANGS .....	16
INSTALLATION .....	17
TOOLS.....	17
SILICONE INSTALLATION.....	17
KEEP-NUT INSTALLATION .....	17
THREAD CUTTING SCREW INSTALLATION.....	17
<b>SPECIAL APPLICATION: FABRICATION OF TABLETOPS.....</b>	<b>18</b>
TABLETOP GENERAL .....	18
KEEP NUT INSTALLATION.....	18
THREAD CUTTING SCREW INSTALLATION .....	18
<b>SPECIAL APPLICATION: MOBILE LIVING ISLAND INSTALLATION AND WARPAGE PREVENTION.....</b>	<b>19</b>
MANDATORY L-BRACKET USE.....	19
MECHANICAL FASTENING .....	19
PRE-DRILLING REQUIREMENTS .....	19
<b>THINSCAPE® COLOR MATCHED ADHESIVE AND CAULK .....</b>	<b>20</b>
ADHESIVE CORE MATCHING COLORS .....	20
COLOR MATCHING CAULK .....	21
<b>CUSTOMER SUPPORT .....</b>	<b>22</b>
TECHNICAL SUPPORT.....	22
CUSTOMER SATISFACTION.....	22
<b>APPENDIX.....</b>	<b>23</b>
TOOL MANUFACTURERS .....	23

## GENERAL SAFETY

Safety is a critical concern for any shop and key to a successful business. The following safety rules should be incorporated into your safety program to help prevent an accident. Safety training, knowledge, product use and environment are the responsibility of the facility owner and the shop employees.

### **CAUTION: ALWAYS FOLLOW PRODUCT, EQUIPMENT AND/OR TOOL MANUFACTURER'S RECOMMENDATIONS AND INSTRUCTIONS CAREFULLY.**

- Read directions carefully before fabricating/installing Thinscape Composite Tops.
- Read and follow the instruction manual before operating the different tools.
- Keep all guards in place and in working order.
- Ensure all tools are properly grounded. Never remove the third prong.
- Keep work area clean, uncluttered and well lit.
- Don't use electric power tools in a damp or wet work area.
- Always use safety glasses or approved eye protection and/or face shield, ear/noise protectors and safety shoes.
- Wear the proper apparel, no loose clothing or jewelry.
- Secure all work with the proper clamp or vise to a stable work surface.
- Don't overreach. Keep proper footing & balance at all times.
- Maintain tools in top condition. Disconnect tools before servicing and when changing accessories such as blades, bits, cutters, etc.
- Keep and use denatured alcohol, adhesives and materials in a safe, ventilated place.
- Dust collection should be used when cutting, routing and sanding. Tools should be used with dust collection at all times.
- **ALWAYS** refer to the specific Technical Data Sheet and Material Safety Data Sheet for instructions and health/safety concerns. For information about Wilsonart® Adhesives, contact [wilsonartadhesives.com](http://wilsonartadhesives.com) or the Wilsonart Hotline at 1-800-433-3222.

# BEFORE YOU START-QUICK REFERENCE

Be sure to check out our video online: [Thinscape Fabrication and Installation Video](#)

## STORAGE AND HANDLING

### Acclimate Material

Allow product to acclimate indoors for a minimum of 72 hours.

### Handling

Maintain airflow to both sides to prevent cupping/warping.

Remove protective peel coat prior to fabrication or installation.

If removing the protective peel coat, remove it from both faces.

Store Thinscape flat (not on edge). When stored horizontally without plastic peel coating, cover with plastic poly sheeting.

## FABRICATION

### Inspect Material

Verify consistent thickness and inspect for defects before fabrication. Each slab has two usable faces—select the best side. Remove protective peel coating from both sides prior to fabrication or installation.

### Manual Cutting

Use a sharp 60–80 tooth blade for clean cuts. Fully support the material and use a straight edge for accuracy.

### CNC Machining

Use sharp tooling. Operate at 16,000–18,000 RPM with travel speeds of 200–900 IPM. Reduce speed as tooling dulls. Use multiple step-downs and test on scrap before final cuts.

### Edge Profiling

Use carbide or diamond router bits designed for hard composites to create custom edge profiles.

### Edge Finishing

Sand edges only using a multi-step process from coarse to fine grit. Do not sand the top surface. Refer to the fabrication guide for sanding details.

### Seaming

Lightly sand cut edges to ensure good epoxy adhesion. Use a 2-part acrylic adhesive/epoxy for all structural seams. Mask seam areas with tape to control squeeze-out. DO NOT use heat gun to cure or wood glue to seam. Remove excess adhesive with acetone or denatured alcohol after it gels, before full cure.

### Cooktop Cutouts

Wrap all cutout edges with aluminum heat-reflective tape to reduce thermal shock risk.

## **INSTALLATION**

### **DO**

#### **Level Cabinets**

Ensure cabinets are level within 1/8" over 10 feet and fully supported.

#### **Dry Fit**

Dry fit all components before applying adhesive to ensure proper alignment and seam fit.

#### **Support Seams**

Place structural support within 3" of all field seams.

#### **Limit Edge Overhang**

Limit unsupported overhangs to 6". Provide support every 24" along cabinet runs.

#### **Affixing the Top**

Use 100% silicone adhesive or L-brackets. Apply silicone evenly and clamp until cured.

For island tops, secure each corner with L-brackets and Keep-Nut™ insert or thread cutting screws.

### **DON'T**

#### **No Mitered/Built Down Edges or Waterfalls**

**DO NOT** incorporate these configurations as they are not supported.

#### **No Substrate (base material)**

**DO NOT** install over a solid surface base substrate (plywood, particle board, etc.).

Install directly on open top cabinets or framing to prevent warp from moisture imbalance.

#### **Wall Backsplash (Large/Oversized)**

**DO NOT** seal top or bottom edges—airflow is required. Apply ¼" vertical silicone beads 5/8" from edges, then every 4". Do not spread. Start and stop beads ½" from top and bottom.

Refer to the fabrication and installation guide for full details.

## STORAGE AND HANDLING

### HANDLING

Care should be taken when handling Thinscape to protect employees and the decorative surface of the product. Large panels should be transported by pallet/fork-truck or rolling table. Vacuum lifts are also recommended for handling large panels. Additional tips:

- Place padding (slip-sheet or protective cardboard strips) between panels when stacking.
- Carry vertically to limit flex and possible breakage.
- If removing the protective film coat, remove it from both faces.
- Remove protective film coat just prior to fabrication or installation.
- Maintain airflow to both sides to prevent cupping/warping.

### STORAGE

- Thinscape Composite Tops in original packing with plastic film coating on the face and back in tack.
- Thinscape Composite Tops should be stored in a controlled, moderate climate.
- Avoid storing in excessive heat/humidity extremes.
- All materials should be acclimated for a minimum of 72 hours before fabrication/installation.
- Material should not be stored near exterior doors that may result in exposure to rain or temperature/humidity variations.
- Store Thinscape flat (not on edge). When stored horizontally without protective film coating, cover with plastic poly sheeting

### INSPECTION

Every effort has been made to supply high quality materials, free of defects. However, as the fabricator, you must conduct a final (pre-cut) inspection for manufacturing defects or damages to continue the quality control process prior to fabrication.

### SHEET SELECTION PROCESS

Thinscape Composite Tops have product information on labels that are adhered to each sheet for proper identification.

**FAB TIP: BE SURE AND REMOVE FILM COAT FROM TOP AND BOTTOM OF THINSCAPE SUBSTRATE BEFORE INSTALLING.**

## **JOBSITE PREPARATION**

- Based on the thickness of the final Thinscape application, consideration of cabinets and appliances must be made during the planning stages.
- Do not install Thinscape over a solid substrate. Air movement must be allowed to reach the top and bottom of the slab. Warpage may occur due to changes in temperature and humidity. Where a full substrate is required, holes can be cut in the substrate to allow air movement.
- Supports are required every 24".
- Ensure cabinets are leveled. Shims may be used for assistance.
- Certain unsupported areas need stronger frame material. These include inside corner cabinets, especially for a Lazy Susan, dishwasher openings, sink base fronts, desks and anywhere else that the cabinet is weaker.
- Place cabinet supports at both sides of all cutouts.
- Place supports no closer than 1" (25.4mm) and no further than 3" (76.2mm) from sides of cutout.
- Multiple bowl installations require special reinforcement to provide adequate support.
- Place cabinet support along both sides of the bowl installation.
- Place sink setters, solid wood, MDF or plywood supports between each bowl.
- Supports must be attached to cabinet base to alleviate flexing.
- Free standing stoves must be set at a minimum of 1/16" higher than the surface of the countertop.
- Insert method is recommended to be used for dishwasher clips only.

## RECOMMENDED TOOLS

The following suggested tool list is only a minimum requirement for professional and successful Thinscape fabrication. Various woodworking and specialized fabrication tools are available in the market today. Please see the Appendix for a list of tooling manufacturers.

### STATIONARY TOOLS

- Table or Panel Saw
- Miter ("Chop") Saw
- Triple Chip Carbide Saw Blades

### HAND & POWER TOOLS

- Routers: 3-1/4 HP with 1/2" (13mm) collet; 3-1/4 HP Plunge base with 1/2" (13mm) collet; 1-1/2 to 2-1/2 HP with 1/2" (13mm) collet (edge details)
- General Router Bits: 1/2" (13mm) Straight cut; 1/2" (13mm) Bottom bearing flush trim bit; 1" (25.4mm) Top bearing flush trim bit; Various profile bits
- Sanders – Random Orbital
- Dust collection system (suggested)
- Sanding Disks (Micron and Grit Papers)
- Mirka Abralon pads
- Straight Edges (Phenolic or Aluminum)
- Clamps

# GENERAL TOPS, COUNTERTOPS, AND BACKSPLASHES

## DECK SEAMS

See page 14 for Wilsonart Color Matched Adhesives and Caulk

### CONVENTIONAL SEAM

- Machine both edges to be seamed. Slightly oversize Thinscape Composite Tops parts by a maximum of 1/8". Both sides must be routed for a proper dry fit and quality seam.
- Seams should fit tightly when dry fitted.
- Alignment biscuits/wafers or slot bits are required for alignment and leveling.
- For alignment, use biscuit slot cutter or slot bit to machine slots for #20 biscuits.
- Minimum of 4 biscuits are required for butt seam or 45° seam. Biscuits on ends must be 3" from inside and outside corners. Other biscuits should be distributed evenly for maximum alignment and leveling.
- Dry fit seams to insure a tight fit. Place clear packing tape (or other release material) under seam area to prevent contamination.
- Thoroughly clean areas to be seamed with denatured alcohol using clean white shop rag.
- Position sheets to be seamed 3/16" (4.8mm) to 1/4" (6.4mm) apart.
- Prepare clamping materials.
- Prepare 2-part acrylic epoxy seam kits. Wilsonart recommends using a 15-to-20-minute epoxy to allow time for proper leveling and clamping.
- Fill the seam to 1/2 full and biscuit slots, apply biscuits.
- Slide the sheets together — make sure there is adhesive squeeze out along entire seam. Clamp the seam together using bar clamps, suction cups, wood blocks or spring clamps.
- **DO NOT OVERTIGHTEN** clamps. Overtightening will cause starved, weak seams.
- Clean seam area with denatured alcohol and clean white shop rag.
- Do not scrape, chisel or remove adhesive prior to being fully cured.

### 45° SEAM

This method is recommended to be used for movement or directional designs. Conventional 45° seams are the preferred method for seaming, allowing the pattern movement to continue throughout the application and flow in similar direction through the angle or corner.

- Machine both edges to be seamed.
- Alignment biscuits/wafers or slot bits are required for alignment, leveling and to eliminate movement of 45° seaming process. Use of 2-part acrylic epoxy adhesive is recommended.
- Minimum of 4 biscuits are recommended for butt seam or 45° seam. Biscuits on ends must be 3" from inside and back corners. Other biscuits should be distributed evenly for maximum alignment and leveling.
- Seams should fit tightly when dry fitted.
- Place a release material (such as packing tape) under the seam to prevent contamination of deck seam.
- Thoroughly clean areas to be seamed with denatured alcohol using clean white shop rag.
- Position sheets to be seamed 3/16" (4.8mm) to 1/4" (6.4mm) apart.
- Prepare 2-part acrylic epoxy seam kits. Wilsonart recommends using a 15-to-20-minute epoxy.

Wilsonart.com | 800-433-3222 | ©2026 Wilsonart LLC

2501 Wilsonart Drive, P.O. Box 6110, Temple, TX 76503-6110

- Slide the sheets together, making sure there is adhesive squeeze out along the entire length of the seam.
- Clamp the seam together using selected clamping process; wood blocks or suction cups with spring clamps, bar clamps and/or other seaming system.

## **CUTTING AND ROUTING**

### **CUTTING & ROUTING (DRY)**

- Based on the thickness of the final Thinscape application, consideration of cabinets and appliances must be made during the planning stages.
- When working with Thinscape, slower feed-speeds should be expected due to the density of the material (as compared to HPL on particleboard/MDF).
- It is always appropriate to contact your tooling supplier for specific recommendations for feed, speed, and tool geometry.
- While good quality carbide proves effective for small projects, diamond cutting tips may be more durable and cost effective.
- Rate of advance of the cutter (chip load) should be .001" to .002".
- Triple chip designs have shown to provide good quality cuts. Saw blades need to have slight negative to no hook.
- Panel saws with a "scoring-saw" option can minimize chipping on the exit side of the panel.
- While surface wear inhibitors can be a factor in tool life, the enemy in any machining process is heat.
- Cutting rates and feed speeds play a major role in both the practical life of tooling, as well as the quality of cuts during machining. Specific machines and tool types will vary and specific parameters will have to be established on site.
- Only use recommended cleaners per the care and maintenance sheet.
- Colored or printed towels can leave a residue which will contaminate the seam material and cause a weak or stained bond line.
- Postforming is not recommended or approved by Wilsonart for Thinscape. Please contact Wilsonart Technical Service Group at 800-433-3222 for further information.
- All edges should be sanded smooth and free of sharp corners and kerf marks, which result in stress points.
- Hand Routing: For best results, finished edges of Thinscape should be routed/milled. Rough cut panels to approximately 1/16" before finish routing. It is best to use cutters with larger diameter shanks (1/2"). Two-flute carbide straight cutting bits work well for trimming.
- CNC Routing: The appropriate cutting sequence is largely determined by the type of machining required. Specific panel thickness, cutting sequence, and machine condition will require that you "tune" adjustments for your particular process.
- A good starting point for machining is: Spindle speed: 16,000–18,000 RPM; Feed-rate: 200–900 in/min.

### **WET SAW CUTTING**

- When working with Thinscape, it is always appropriate to contact your machine and tooling supplier for specific recommendations for feed, speed, and programming.
- Wet cutting equipment can vary between each machine. Proper maintenance of the blade and waterjet is important to producing clean cuts.

- When cutting with a wet saw blade such as an 18" Zenesis, ensure that the blade depth is set to cut through the Thinscape material. If a thin layer remains, chipping on the bottom side can occur.
- A feed rate of 120 inches per min can be set, and the percentage can be adjusted depending on your needs and machine. Thinscape slabs may need to be secured or blocked to ensure the slab does not move during the cutting process.
- A standard target of 9 amps is desired, with a fixed down feed of 10 inches per minute.
- The cut from your wet saw should not contain any burn marks or rough edges. The finishing steps should include light dry sanding of the top and bottom edges with an orbital sander (120 grit on the top and bottom edge, and finish with a 500 Mirka Abralon pad).

## **WET JET CUTTING**

- There are two options on cutting with a water jet. One is initiating the jet from the previous wet saw kerf. The second is plunging through the center of the slab for a circular or oval cutout.
- When cutting from the previous saw kerf, the pressure can be set at 65,000 psi traveling at 12 to 14 inches per minute. This will produce a very clean cut with minimal chipping. It is important that the jet starts in the center of the kerf and not on the edge of the Thinscape.
- When punching through a Thinscape slab, it is recommended to start the punch through a minimum of 4" from a finished edge.
- Initial plunge should be between 25,000 to 35,000 psi. After the initial plunge cut, the pressure can be increased to 65,000 psi.
- Finishing the edge is accomplished by sanding with a dry orbital sander (80, 120, 180, 220 Grit, finishing with a Mirka Abralon pad).

## CUTOUTS

### GENERAL CUTOUT REQUIREMENTS

These procedures are for cutouts that do not involve heat generating/producing appliances or items.

- Cutouts must be completed and performed with a router only.
- Inside corners of all cutouts must be radiused.
- Use 1/2" (9.5mm) or larger diameter bits.
- A 1/4" (6.4mm) minimum radius required or larger preferred at all cutout inside corners.
- Round over top and bottom edges of cutouts to a minimum of 1/16" (1.5mm) radius.
- Remove any roughness, nicks and/or router "chatter" with 150-grit (80 micron) or finer sandpaper.
- Allow at least 1/8" (3mm) clearance space on all sides for drop-in sinks and appliances.
- Allow at least 1/16" (1.5mm) clearance space on all sides for outlets.

### SPECIAL CUTOUTS

#### *SINK INSTALLATION — DROP-IN / SELF-RIMMING*

Stainless steel and other material type drop-in sinks/bowls can be installed by following these instructions:

- Inspect sink for imperfections and verify color.
- Identify the location. The distance between the drop-in sink cutout and a seam location must be a minimum of 3" (75mm), while the distance from the front edge of the countertop must be a minimum of 1.5" (40mm).
- Position sink using center-line dimensions. Place the sink upside down on the face of the countertop and mark around the perimeter of the sink flange.
- Using a template, draw a second line at least 3/8" (10mm) to a 1/2" (13mm) inside the first line of the sink perimeter, or to the manufacturer's guidelines.
- Ensure all countertops are adequately supported during all cutting processes.
- Using a 1/2" (13mm) bit, drill each of the 4 corners of the inner line to create a clean radius corner. Minimum 1/4" (6mm) radius required at all inside corner cutout locations. Recommend cutting in stages of 1/8" (4mm) depth increments.
- Dry fit vanity or sink to ensure proper fit.
- Clean Thinscape Composite Tops and vanity/sink flange with denatured alcohol.
- Apply ample amount of 100% silicone to the Thinscape Composite Tops in areas to receive flange of vanity/sink.
- Check for silicone squeeze-out around entire sink area.

#### *SINK INSTALLATION — UNDERMOUNT*

Stainless steel and other material type undermount vanities and sinks can be installed by following the instructions below. It is always recommended to review and follow vanity/sink manufacturer instructions.

- Develop a sink template from particleboard or Thinscape Composite Tops by taking dimensions from vanity/sink and transferring to template material along with center lines.
- For best results, all cutouts must be conducted using a router for template and Thinscape Composite Tops cutouts.
- Fasten template with clamps to the face side of the countertop. The use of an inner template is recommended to support router and can be fastened to face with hot melt.

- Using router with top bearing bit or template guide and 1/2" (13mm) router bit, follow the template with router. Recommend cutting in stages of 1/8" (4mm) depth increments.
- Dry fit sink to ensure proper fit and that dimensions are accurate.
- Thinscape edges can be finished using a multi-step sanding process.
- During the dry fitting process mark locations of sink clips. Use 4-6 sink clips for vanities and 6-8 clips for kitchen sinks.
- With sanding materials, scuff the Wilsonart® Thinscape Composite Top at the bonding location of flange or clip system stems.
- Sink clips can be fastened by using Rotoloc® threaded stems and clips, or by using inserts with threaded stems and clips.
- Wilsonart recommends Keep-Nut™ insert.
- Clean vanity/sink flange and area with denatured alcohol to receive Rotoloc® stems and Devcon/Plexus MA300 or equivalent plastic welder/bonder adhesive.
- SinkSetter, an undermount sink installation kit is also recommended. [sinksetter.com](http://sinksetter.com)
- Avoid securing sink clips to plumbing fixture areas.
- Avoid screwing through the material unless adding wooden strips or plate to secure to.
- Apply 1/4" bead of 100% silicone to the center of the vanity/sink flange. Fit vanity/sink, apply pressure and fasten sink clips using wing nuts. Fasten wings equally and apply pressure evenly.

#### COOKTOP CUTOUTS

- Cutouts must be performed with a router only.
- A minimum 1/4" (6.4mm) gap is required between the edge of Thinscape Composite Tops cutout and cooktop.
- Inside corners of all cutouts must have a minimum radius of 1/4" (6.4mm).
- Round over top and bottom edges of cutout a minimum of 1/16" radius.
- Sand sides of cooktop cutout to be free of roughness, nicks and router "chatter" with minimum 150-grit or finer sandpaper.
- Wrap entire cooktop opening with Wilsonart® 9 mil aluminum heat reflective tape.
- Place an additional layer of tape at all corners. Inform cooktop installer that tape must not be removed. Nomex® will assist with heat resistance.
- Do not fold tape under the bottom of the cutout. Tape must extend past the edge of cooktop flange.
- Trim excess. Never fasten cooktop to Thinscape Composite Tops with mechanical fasteners.
- Use a wood block between Thinscape and the cooktop fasteners. If minimum cutout dimension listed above cannot be met, follow requirements for cooktop mantle or stainless steel ring.

## BACKSPLASHES

### WALL BACKSPLASH-CONVENTIONAL

- Use 100% silicone to adhere backsplash to countertop and wall.
- Apply continuous bead to the bottom of backsplash to be adhered to countertop.
- Apply dots of silicone to backsplash; hot melt adhesive can be used to adhere backsplash to the wall while silicone cures.
- Remove excess silicone squeeze-out, leaving only a small inside corner bead.
- On full height backsplash, apply all Thinscape Composite Tops fabrication guidelines.
- 1/4" (6.4mm) radiused inside corners.
- Space for expansion.
- Cutouts must be made with a router.
- Attach backsplash with silicone.
- Do not hard seam to countertop.

### WALL BACKSPLASH-LARGE/OVERSIZED

- With all Wilsonart Thinscape Composite Tops, 100% silicone adhesive should be used to adhere the product backsplash to the wall.
- Apply 1/4" (7mm) diameter vertical beads of silicone approximately 5/8" (15mm) in from each edge.
- Then, apply vertical beads every 4" (100mm).
- Do not trowel or spread beads prior to installation—the bead format will allow space for proper airflow.
- Be sure to start and stop the bead approximately 1/2" from the bottom and top of the panel.
- The area directly behind the cooktop should also have additional 1/4" (7mm) vertical beads spaced 1" (25.4mm) apart and at least 12" (300mm) high.
- Silicone bead is recommended between countertop and backsplash bottom edge interface and ensure squeeze-out for proper seal of area after clean-up.
- J-Roll the entire Backsplash area to ensure a proper bond.
- Cutouts require a minimum 1/8" radius on all inside corners.

DO NOT seal top or bottom edges—airflow is required. Apply 1/4" vertical silicone beads 5/8" from edges, then every 4". Do not spread. Start and stop beads 1/2" from top and bottom.

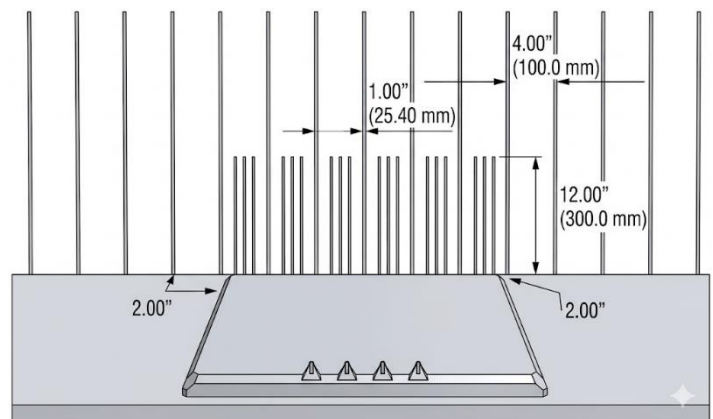

**FAB TIP: DO NOT APPLY A HORIZONTAL BEAD OF SILICONE ON THE TOP OF THE WILSONART® THINSCAPE® COMPOSITE TOP. THIS WILL PREVENT AIR FLOW TO THE BACKSIDE OF THE PANEL.**

Wilsonart.com | 800-433-3222 | ©2026 Wilsonart LLC

2501 Wilsonart Drive, P.O. Box 6110, Temple, TX 76503-6110

## EDGE PROFILING & FINISHING

### EDGE PROFILING

- Wipe sanding dust from countertop edge between sanding steps.
- Exposed edges can be shaped to enhance the appearance and ergonomics of the installation. Typical shapes include: Fillet, Thumbnail, Flat, Reverse-Knife.
- Radius should be limited at the transition to the face in order to minimize the "feathering" of the decorative surface.
- For any other questions concerning edge profiling, please contact the Wilsonart Smartline at 800-433-3222.

### FINISHING

- Machining edges will normally result in slight-to-moderate cutter/kerf marks.
- These edges can be finished by using a random orbital sander to smooth the edges until they possess an attractive appearance.
- Edge finishing is a multi-step sanding process that utilizes large-to-small grit.

FINISH TYPE	USA GRIT	3M™ MICRON
Matte Finish	120, 180, 220 Grit Finishing with Mirka Abralon 360 or Scotch-Brite	100, 80, 60 microns Finishing with Mirka Abralon 360 or Scotch-Brite
Satin Finish	120, 180, 320 Grit Finishing with Mirka Abralon 1000 or Scotch-Brite	100, 80, 60 microns Finishing with Mirka Abralon 1000 or Scotch-Brite
Semi-Gloss Finish	120, 180, 320 Grit Finishing with Mirka Abralon 1000 and 2000 or Scotch-Brite	100, 80, 60 microns Finishing with Mirka Abralon 1000 and 2000 or Scotch-Brite

### Suggested Products

- 3M® Trizact™ Abrasives – 1-800-364-3577 in the U.S.A. | 651-737-6501 outside the U.S.A.
- Mirka Abralon Pads – Recommended for dark colors.

### Standards

- U.S. standard system: 16 grit (coarsest) to 2,000 grit (finest)
- Trizact™: 60mx (coarsest) to 20,000mx (finest)
- Micron system: 100 micron (coarsest) to .3 micron (finest)
- Abralon: Medium (coarsest) to mirror fine (finest)

## OVERHANGS

Additional support is required when the countertop overhangs the cabinet. Refer to the following chart to determine support required:

OVERHANG	SUPPORT REQUIRED
0" to 6" (0-152.4mm)	None
6" to 18" (152.4mm - 304.8mm)	Brackets or Corbels
18" to 24" (457.2mm - 609.6mm)	Brackets (corbels) and Supporting legs

When brackets (corbels) are used, place them no more than 24" (609.6mm) apart. In addition, place brackets 12" (304.8mm) from open ends and against wall ends.

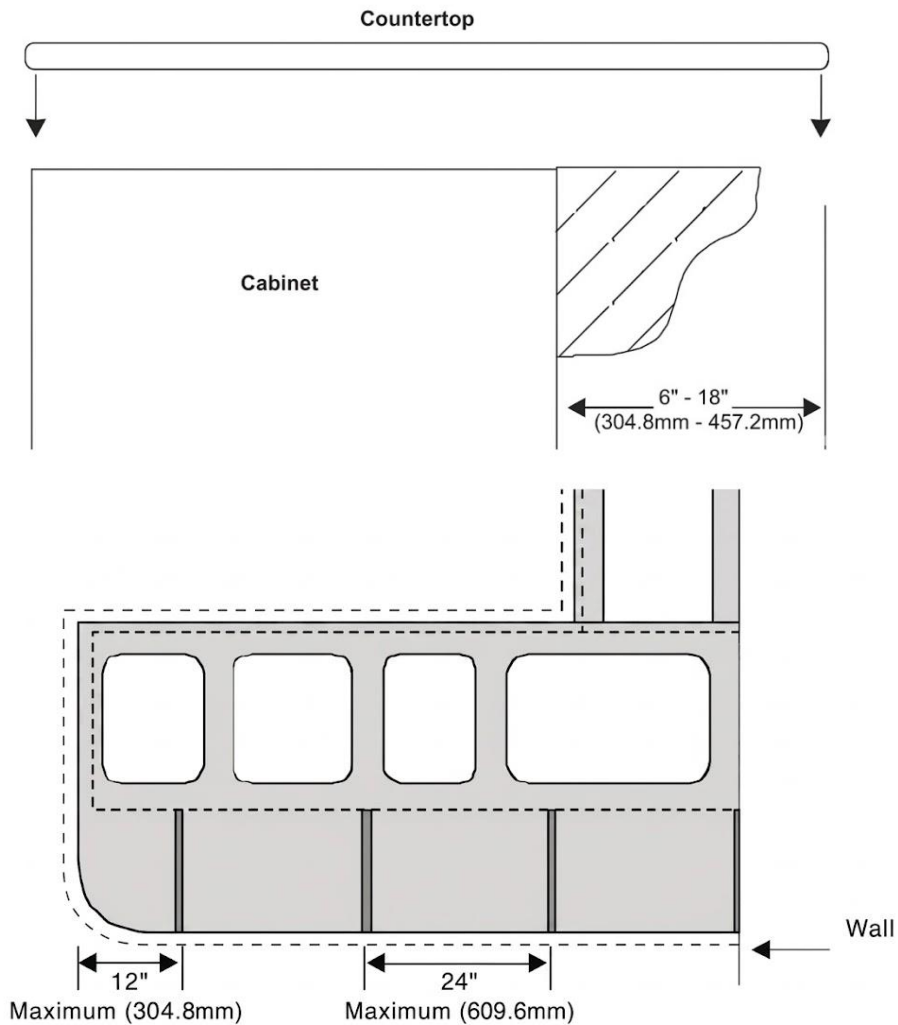

## INSTALLATION

**FAB TIP: BE SURE AND REMOVE FILM COAT FROM TOP AND BOTTOM OF WILSONART THINSCAPE COMPOSITE TOPS BEFORE INSTALLING.**

### TOOLS

- Keep Nut Inserts Keep-Nut™ insert (IM2S-P1.4-20/H6). <https://chemical-concepts.com/>
- Thread cutting screws Type F point thread cutting screw with a machine screw thread with a blunt tapered point, having multi-cutting edges and chip cavities.
- Cordless Drill, Drill Bit
- Hammer
- Silicone

### SILICONE INSTALLATION

- Ensure cabinets are secure and level prior to installation.
- Use only 100% pure silicone to secure countertop to cabinet frame – no construction mastic.
- Use lineal beads of silicone at a minimum width of 1/8".
- Apply bead along the front of cabinet, add dime-sized dabs every 12" (304.8mm) to 18" (457.2mm) along the back of cabinet's supports.
- Do not place silicone in the inside corners.

### KEEP-NUT INSTALLATION

- Wilsonart recommends securing Thinscape Composite Tops to cabinet bases using Keep-Nut inserts, threaded stems, wingnuts, and L-brackets along with silicone.
- Attach L-bracket to corners of cabinet bases using wood screws.
- Pre-mark holes to be drilled by placing the slab on the cabinet base in correct location and mark with a pencil through L-bracket.
- Flip top over and pre-drill holes using Keep-Nut drill bit (11.8mm) and stop collar.
- Using Keep-Nut setting tool and a hammer, insert Keep-Nut inserts into pre-drilled holes by tapping into place & insert threaded stems.
- Apply silicone to cabinet base as described in previous section.
- Flip the slab back over and align the slab to the cabinet base using the threaded stems and L-brackets.
- Tighten with wing nuts.

### THREAD CUTTING SCREW INSTALLATION

- Wilsonart recommends securing Thinscape Tops to cabinet bases using proper sized Type F thread cutting screws, L-brackets or figure 8 fasteners, and silicone.
- Attach brackets or fasteners to corners of cabinet bases using wood screws.
- Pre-mark holes to be drilled by placing the slab on the cabinet base in correct location, mark with a pencil through bracket or fastener.
- Flip top over and pre-drill holes using appropriate drill bit and stop collar.
- Apply silicone to cabinet base as described in previous section.

- Flip the slab back over and align the holes in the slab with the bracket or fasteners and screw the Type F thread cutting screws into the slab, being careful not to over tighten.

**FAB TIP: BE SURE AND CLEAN OUT HOLES TO ALLOW ROOM FOR TYPE F SCREW.**

## **SPECIAL APPLICATION: FABRICATION OF TABLETOPS**

### **TABLETOP GENERAL**

- Support for the Thinscape Composite Tops composite material is critical when choosing table bases.
- Choose a base that is going to provide the necessary support and balance for the appropriate size tabletop.
- 36" or 42" Tabletops are recommended. Larger tops will require additional support.
- Single corner legs are not recommended unless additional support or framing is applied.

### **KEEP NUT INSTALLATION**

- Thinscape Composite Tops can be fastened to table base using Keep Nut inserts threaded stems and wingnuts.
- Pre-mark holes by placing table base on backside of the slab and marking with a pencil.
- Pre-drill holes using Keep Nut drill bit (11.8mm) and stop collar.
- Using setting tool and hammer, insert Keep Nut inserts into pre-drilled holes by tapping into place.
- Insert threaded stems. Align table base onto stems and use wing nuts to tighten.

### **THREAD CUTTING SCREW INSTALLATION**

- Thinscape Composite Tops can be fastened to table base using a proper sized thread cutting screw.
- Pre-mark holes by placing table base on backside of the slab and marking with a pencil.
- Pre-drill holes using appropriate drill bit and stop collar.
- Align table base with pre-drilled holes and insert thread cutting screws and tighten.

**FAB TIP: BE SURE AND CLEAN OUT HOLES TO ALLOW ROOM FOR SCREW.**

## **SPECIAL APPLICATION: MOBILE LIVING ISLAND INSTALLATION AND WARPAGE PREVENTION**

In mobile living applications, surfaces frequently move between acclimated and non-acclimated environments. Changes in temperature and humidity can lead to warpage if the product is not properly secured.

**To maintain the integrity of the installation and prevent movement:**

### **MANDATORY L-BRACKET USE**

All Thinscape island applications must be held down using L-brackets (all 4 corners) in addition to 100% pure silicone.

### **MECHANICAL FASTENING**

Use either Keep-Nut™ inserts with threaded stems and wingnuts or appropriately sized Type F thread-cutting screws to mechanically fasten the L-brackets to the underside of the Thinscape slab.

### **PRE-DRILLING REQUIREMENTS**

When installing fasteners, always pre-drill holes using a stop collar to prevent drilling through the decorative face.

## THINSCAPE® COLOR MATCHED ADHESIVE AND CAULK

Wilsonart recommends using 2-part acrylic epoxy with plastic weld or plastic bonder identifiers on the package. Devcon Plastic Welder Plexus MA300 and Loctite Epoxy Plastic Bonder are two recommended 2-part acrylic epoxy.

### ADHESIVE CORE MATCHING COLORS

Available in 50 ML tubes or 10 pack.

Design Series	Adhesive Number	Core Color	Individual Part Number	Case of 10 Part Number
TS100	WA-TS100	Khaki Core	WA-TS100-DESIGNS-EACH	WA-TS100-DESIGNS-CASE-10
TS300	WA-TS300	Grey Core	WA-TS300-DESIGNS-EACH	WA-TS300-DESIGNS-CASE-10
TS400	WA-TS400	Black Core	WA-TS400-DESIGNS-EACH	WA-TS400-DESIGNS-CASE-10
TS500	WA-TS500	White Core	WA-TS500-DESIGNS-EACH	WA-TS500-DESIGNS-CASE-10

New adhesive tube comes with a standard caulk gun adapter and extra mixing tip.



## COLOR MATCHING CAULK

Available in 5.5 ounce tubes and 10.5 cartridges.

DESIGNNUMBER	DESIGNNAME	CAULKNUMBER
TS103	Artisian Weave	W0202
TS104	Sunwashed Oak	W1028
TS105	Sandrift Cherry	W0038
TS202	Midday Mahal	W1066
TS203	Yamuna Quartzite	W1053
TS306	Spanish Limestone	W0005
TS307	Soapstone Mist	W0206
TS308	Sterling Calcutta	W1050
TS311	Taj Mahal	W0005
TS315	Sea Line Mist	W0001
TS316	Serene Weave	W1050
TS317	Coastal Weave	W0005
TS318	Urbane Lattice	W0206
TS319	Mistral Grey	W0200

DESIGNNUMBER	DESIGNNAME	CAULKNUMBER
TS404	Black Amani	W0216
TS405	Pietra Noir	W0219
TS406	Bosco Oscuro	W1064
TS407	Embered Eucalyptus	W0212
TS408	Shadow Webbing	W0216
TS409	Golden Shores Teak	W1018
TS411	Espresso Etimoe	W0218
TS412	Notee Nera	W0219
TS501	Calcutta Blanc	W0001
TS503	Italian Carrara	W1053
TS504	Volakas Marble	W1053
TS508	Solenne Marble	W0001
TS511	Soluna	W0001
TS512	Cloudspun	W0001



Wilsonart.com | 800-433-3222 | ©2026 Wilsonart LLC

2501 Wilsonart Drive, P.O. Box 6110, Temple, TX 76503-6110

## **CUSTOMER SUPPORT**

### **TECHNICAL SUPPORT**

For specific fabrication and installation support please see Wilsonart resources at

<https://www.wilsonart.com/fabrication>

### **CUSTOMER SATISFACTION**

Customer satisfaction is achieved by using a commonsense approach. Treat your customer fairly. Word of mouth is the best and least expensive form of advertising. Quality assurance in fabrication and installation is of the utmost importance, as the fabricator's reputation depends upon this.

The following is mandatory:

- Care and Maintenance information should be provided to end user. Information can be found at the Wilsonart website. [www.wilsonart.com/care-and-maintenance](http://www.wilsonart.com/care-and-maintenance)

# APPENDIX

## TOOL MANUFACTURERS

### STATIONARY TOOLS

Powermatic 1-800-274-6848 | powermatic.com | Delta 1-800-223-727 | Holz-Her 1-704-587-3400 | holzher.com | Striebig 1-781-585-4364 | csaw.com

### SAW BLADES

Amana Tool 1-800-445-0077 | amanatool.com | Guhdo 1-800-544-8436 | guhdo.com | DML 1-800-242-7003 | Forrest 1-800-733-7111 | FS Tool 1-800-387-9723 | Leitz 1-800-253-6070

### ROUTER BITS

Amana Tool 1-800-445-0077 | Velepec 1-800-365-6636 | Southeast Tool 877-465-7012 | Infinity Tools 877-872-2487

### SANDING EQUIPMENT

Fein 1-800-441-9878 | feinus.com | Festool 1-800-423-3531 | Surcare 1-800-669-5519 | Dynabrade 1-716-631-0100 | Master Power 1-866-557-8316

### SANDPAPER/FINISHING PADS

3M Scotch-Brite & Trizact 1-800-742-9546 | Micro Mesh 1-908-788-5550 | Mirka 1-800-843-3904 | Sia 1-800-459-3534 | Norton 1-800-446-1119

### PIPE AND BAR CLAMPS

Bessey 1-800-828-1004 | americanclamping.com

### HAND TOOLS / DUSTLESS SANDING SYSTEM

Fein Power Tools 1-800-441-9878 | feinus.com | Porter Cable 1-888-848-5175 | portercable.com

### FABRICATION TOOLS

Align-Rite Tool Co. 1-888-624-1942 | alignritetool.com

### VACUUM BASE SEAM LEVELER/CLAMPS

Perfect Seam 1-770-463-8321 | omniced.com | Wood's Power Grip Co. 1-800-548-7341 | powergrip.com

### MISCELLANEOUS TOOLS

Betterley Industries 1-800-871-7516 | Karran® Sinks 410-975-0128 | karran.com | DeWalt 1-800-433-9258 | Chemical Concepts 1-800-220-1966 | Specialty Tools 1-800-669-5519

### WILSONART RECOMMENDS

Keep-Nut™ Insert IM2S-P1.4-20/H6 | chemical-concepts.com | Infinity Tools 877-872-2487